

PRODUCT SPECIFICATION DRAWING
HOLDRITE® #111-S
Supports copper water lines vertically or
horizontally off of adjacent piping

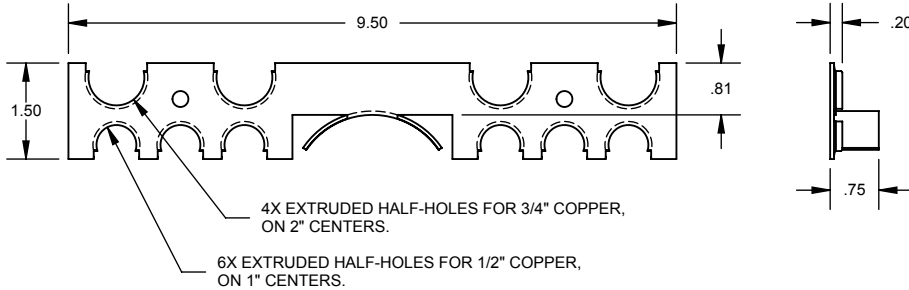

ALL DIMENSIONS IN INCHES

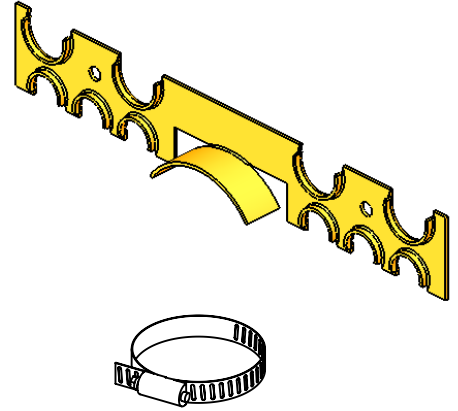

4" Stainless Steel Band

The **HOLDRITE #111-S** is **Copper-Bonded™** steel and supports both 1/2" and 3/4" pipes. Designed to fit within a 3-1/2" wall. The #111-S positions water supplies for lavatories and other fixtures. Mount the #111-S to the vertical vent or waste pipe with the self-locking 4" stainless steel band using the isolating felt and solder your pipes to the bracket. The 1/2" notches provide 4", 6" or 8" centers, while the 3/4" notches provide 4" or 8" centers. When soldering, heat the pipe, not the bracket.

Product Information:

- Material: 16 gage CRS, Copper-Bonded™
- Load rating: 25 pounds
- UPC / IPC / IAPMO listed



THIS INFORMATION IS PROPRIETARY TO HUBBARD ENTERPRISES AND IS SUBJECT TO CHANGE WITHOUT NOTICE. ANY REPRODUCTION IN PART OR WHOLE WITHOUT THE WRITTEN PERMISSION OF HUBBARD ENTERPRISES IS PROHIBITED.

.....**HUBBARD ENTERPRISES**.....
HOLDRITE®
 "Converting Makeshift Methods into Engineered Solutions"

Product Submittal	
Job Name:	
Date:	
Part Number:	Qty:
Architect / Owner:	
Contractor:	
Notes:	