

PRODUCT SPECIFICATION DRAWING HOLDRITE® #424, #425 & #426 Inserts

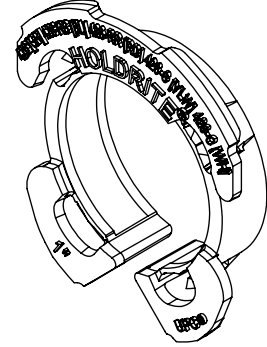

ALL DIMENSIONS IN INCHES

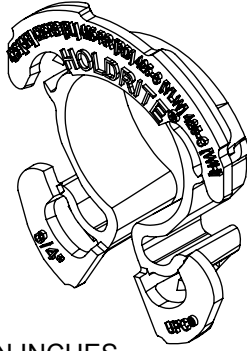
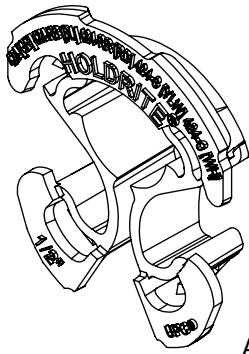
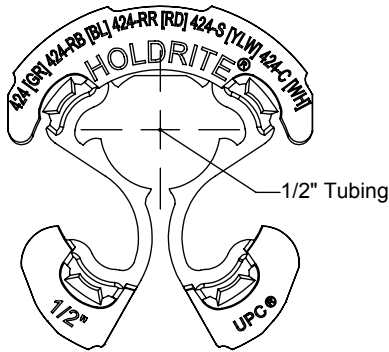
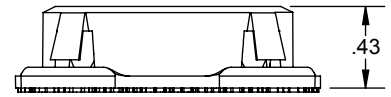
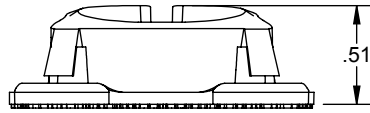
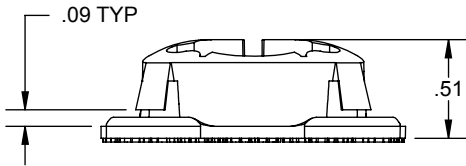

#424

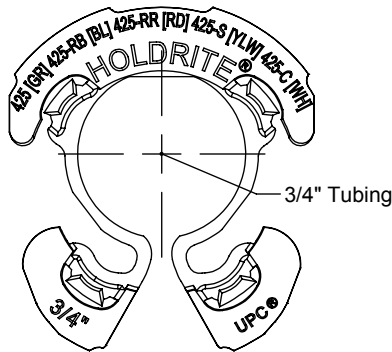

#425

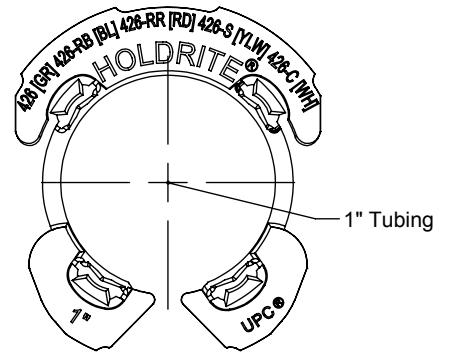

#426

For used with 1-11/32" or 1-3/8" round cut-outs in 14 to 25 gage sheet metal.
Ideal for isolation of Copper, PEX or CPVC tubing.

Product Information:

- Material: Polypropylene, Light Gray, UL94HB
- Temperature range: -10°F to 180°F
- UPC / IPC / IAPMO listed



THIS INFORMATION IS PROPRIETARY TO HUBBARD ENTERPRISES AND IS SUBJECT TO CHANGE WITHOUT NOTICE. ANY REPRODUCTION IN PART OR WHOLE WITHOUT THE WRITTEN PERMISSION OF HUBBARD ENTERPRISES IS PROHIBITED.

••••HUBBARD ENTERPRISES••••
HOLDRITE®
"Converting Makeshift Methods into Engineered Solutions"

Product Submittal	
Job Name:	
Date:	
Part Number:	Qty:
Architect / Owner:	
Contractor:	
Notes:	