

PRODUCT SPECIFICATION DRAWING
HOLDRITE® #AA-0304 Aerator Adapter Box

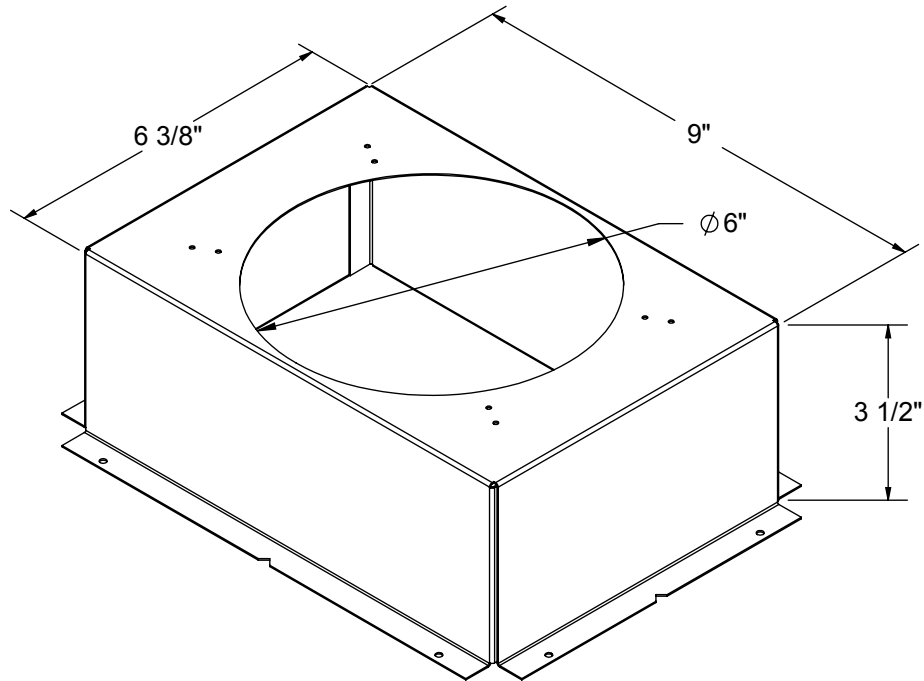

THE HOLDRITE® Aerator Adapter Box provides a 3 1/2" deep recess in the lower portion of a concrete floor slab to allow for connection of drain, waste or vent fittings that are positioned high and tight to a ceiling surface. Accepts 3" & 4" HydroFlame Sleeves.

Product Information:

- Material: 24GA CRS, Galvanized
- Load rating: 25 lbs
- Accepts 3" & 4" HydroFlame Sleeves
- Patent pending

Product Submittal	
Job Name:	
Date:	
Part Number:	Qty:
Architect / Owner:	
Contractor:	
Notes:	

