

CAST-IN-PLACE CABLE CHASE SLEEVE

For use in

- Dust and fiber free environments such as hospitals, computer centers and laboratories
- Concrete floor assemblies with flat form decks

Product Description

- HydroFlame cable chase sleeves offer fire and water protection for a variety of cable sizes and types that pass through concrete floors in single and multi-story buildings
- These one step sleeves are delivered to the job site completely assembled and need only be fastened to the wood form deck for installation
- Tested and approved by UL
- OSHA compliant safety cap

Cable Through Penetrants

Miscellaneous cables

Note: Please refer to the UL listings for the appropriate cable penetrants

Product Feature & Benefits

- Simple and quick installation
- Helps prevent water, fire, smoke, moisture & mold intrusion
- Sleeves are pre-cut at the factory to your specified height

Not for use in

- Walls

Safety & Precautions

- Keep this device out of reach of children
- Read the Material & Safety Data Sheet

Storage of Device

- Store in a covered or closed area protected from weather
- Do not stack devices on top of one another other than how they are shipped from manufacture



Technical Data for HYDROFLAME Firestop Material

Physical Properties	
Color: Gray/Black	
Heat Expansion (Intumescence)	
Expansion begins:	410°F (210°C)
Significant expansion:	555°F (290°C)
Free expansion:	25 times (5 min @ 662°[350°C])
Weatherability (Tested to ASTM G23 and G53)	
Test Condition	Temperature/Humidity 90°F (32°C)/90%
Time	120 Days
After Exposure	No change in expansion
Surface Burning Characteristics (ASTM E84, UL 723)	
Flame spread index: 0	
Smoke development index: 5	
Testing Data	
UL Fire Tested & Listed to UL 1479 (ASTM E814) Standards	
L Rating UL	
W Rating UL	
F Rating UL – 3 Hours	



Installation Instructions

- (1) Lay out lines on the wood form deck for the appropriate location of sleeve; center sleeve with the hatch marks on the sleeve base with the layout lines on the wood form deck. **Note: It is recommended to use 6 penny nails through the nail slots to secure device to the deck. You may use appropriate staples to secure the device to form deck by straddling the nail slots on the edge of the base. DO NOT USE SCREWS TO SECURE THE DEVICE TO FORM DECK BECAUSE THE FORM DECK OR DEVICE COULD BE DAMAGED.** A Minimum of 4 holes should be used for nailing the sleeve to the wood form deck.
- (2) Before pouring of concrete slab, be sure the protective cap on top of sleeve is in place before concrete pour. Pour concrete around sleeve to the appropriate concrete thickness.
- (3) After concrete has cured remove wood form deck and the protective cap from the top portion of device before inserting cable/cables.
- (4) Insert cable/cables up through the bottom of the sleeve and fire ring, support cable/cables with appropriate support on each side of Cable Chase Sleeve after cable/cables have been inserted through the sleeve. **Note: Take precaution when cable/cables are inserted up through bottom of sleeve not to damage fire ring.**
- (5) After cable/cables have been inserted up through bottom of sleeve and properly supported on each side of Cable Chase Sleeve, pack mineral wool in top of sleeve around each cable approximately 2 inches in depth min and compressed down into the top of the sleeve so there is a ¼" from the top of sleeve to the top of mineral wool. To achieve water seal use 3M products FB-1000 NS, FB-3000 WT or FB-1003 SL sealant to fill the top of the packed mineral wool and around each cable to form a water tight seal. Sealant to lap a min ½" onto the top surface of concrete around perimeter of firestop device. Please refer to UL listing XHEZ.F-A-3052 for full details. **Note: HOLDRITE HYDROFLAME is not responsible for sleeve performance when installation instructions are not followed.**

Note #1

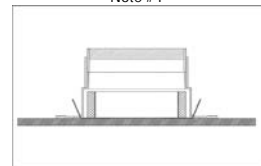

Note #2

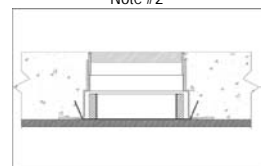

Note #3

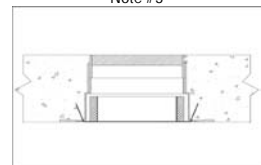

Notes #4 & 5

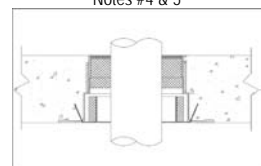

Product Submittal		
Job Name:	Architect/Owner:	
Date:	Contractor:	
Part#:	Qty:	Notes:

Rev B