

WOOD FORM DECK CAST-IN-PLACE SLEEVE

For use in

- Concrete floor assemblies on flat form decks.

Product Description

- HydroFlame wood deck sleeves offer a passage way for a variety of pipe sizes and types that pass through concrete floors in multi-story buildings.
- These sleeves are delivered to the job site completely assembled and need only be fastened to the form deck for final installation.
- HydroFlame sleeves appreciably reduce job time and material expenses by not requiring core drilling or other apparatuses to form a void in the floor for the passage of different piping systems and types.

Through Penetrants

1/2" - 6" pipe sizes: Steel Pipe, Iron Pipe, Conduit (Steel conduit or electrical metallic tubing), Copper Tubing, PEX, Copper Pipe, PVC, CPVC, ABS etc...

Product Feature & Benefits

- Simple and quick installation
- Reduces time to form a void in the concrete floor for the passage of different piping systems and types
- Very rigid during concrete pour
- OSHA compliant Safety Cap included
- Sleeves are pre-cut at the factory to your specified height

Not for use in

- Walls

Storage of Device

- Store in factory boxes and desired location on jobsite or other preferred area

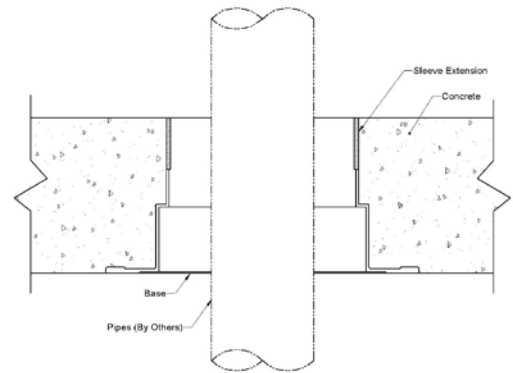

Installation Instructions

- Lay out the form deck for the appropriate location.
- Select the correct sleeve for pipe size and concrete thickness. Align the hatch marks on lower base to layout lines on form deck to center the sleeve for the pipe that will penetrate through. Attach sleeve to deck through the holes provided in the lower base. Make sure the protective cap is securely inserted in the sleeve top before pouring concrete.
- Pour the concrete slab around the device to the appropriate slab thickness.
- Remove the protective cap from the top portion of the sleeve after concrete has cured, before inserting pipe.
- Insert your pipe of choice through the bottom or top of the sleeve.
- Note: Holdrite HydroFlame is not responsible for sleeve performance when installation instructions are not followed.
- Note: Fire Protection by Others for nonmetallic pipe, refer to UL System No. F-A-1122 & F-A-5043 for metallic pipe types & sizes through concrete decks for UL ratings.

Product Submittal		
Job Name:	Architect/Owner:	
Date:	Contractor:	
Part#:	Qty:	Notes:

spec_HFWFD_RevC