

#103-18/103-26



HOLDRITE® Lock-N-Load™ # 702 PIPE SUPPORT CLAMP

IDEAL FOR WATER HEATERS

The **#702 (3/4" insert clamp)**, when combined with the use of the #701 (1/2" insert clamp), provides all of the ideal fixture stub-out solutions for a typical residence. The #702 provides the ideal water heater stub-out support solution when combined with HOLDRITE's #103-18, or #103-26 bracket.

There is no need for special tools, solder, glue or hardware, simply insert the #702 insert clamp into a bracket and tighten by hand!

- Excellent stub-out support clamp for 3/4" CTS tubing
- Compatible with all 3/4" CTS tubing materials: copper, PEX and CPVC
- Ideal for 3/4" water heater rough-in support
- Integrates into a variety of HOLDRITE support brackets #103-18, #103-26, #709 and #721
- Torchless Solution. Provides rigid stub-out support without glue, solder or hardware
- Fast and simple for both professional plumbers and DIYers
- Available through your local Wholesale Plumbing Distributor
- All technical and installation information is available at www.HOLDRITE.com

HOLDRITE® Lock-N-Load™ Products

MODEL #	PIPE SIZE	BOX QTY
701	1/2" CTS	50
702	3/4" CTS	50
103-18	1/2", 3/4", 1" CTS	50
103-26	1/2", 3/4", 1" CTS	50

LT85 | 02/18

INSTALLATION INSTRUCTIONS



Install a **PEXRITE** (#103-18/103-26) bracket onto the front of wall studs.

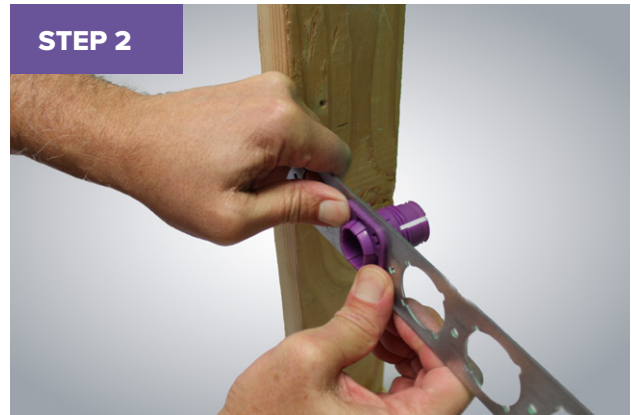

Snap the main purple body of the insert into the front of the bracket.



Snap the grey nut onto the back of the purple insert.



Slide a $\frac{3}{4}$ " tube or bullet through the insert. Lock the tubing in position by tightening the grey nut clockwise, by hand.



Installation is complete.

