

# PRODUCT SPECIFICATION DRAWING

## HOLDRITE® 121-W

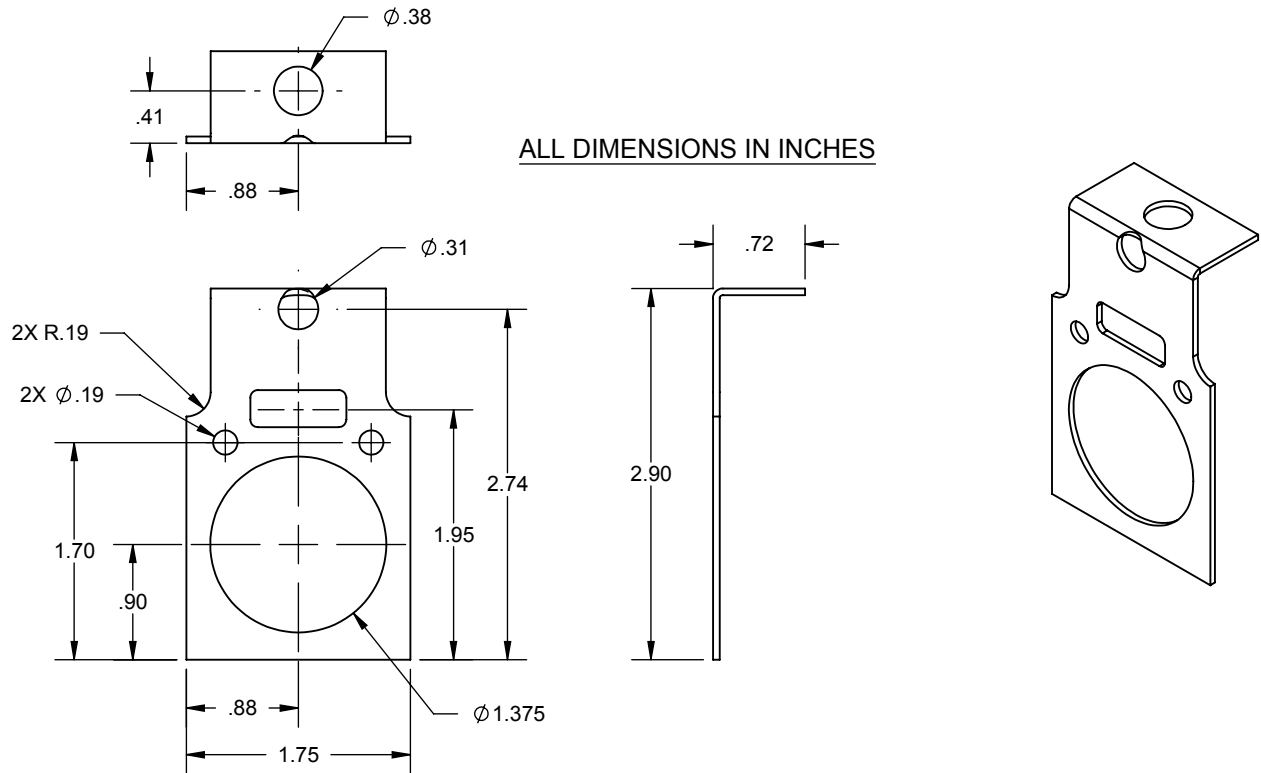

The HOLDRITE® #121-W is a 18 gage galvanized steel bracket with a 2" center line. The bracket will position 1/2", 3/4" and 1" Copper, PEX or CPVC for securing single tubing to any flat surface. The bracket can also be suspended by 1/4" or 3/8" threaded rod.

### Product Information:

- Material: 18 gage CRS, galvanized
- Load rating: 25 pounds
- Supports 1/2", 3/4" and 1" tubing with available inserts
- UPC / IPC / IAPMO listed



THIS INFORMATION IS PROPRIETARY TO HOLDRITE AND IS SUBJECT TO CHANGE WITHOUT NOTICE. IT MAY NOT BE REPRODUCED IN PART OR WHOLE WITHOUT WRITTEN AUTHORIZATION.

# HOLDRITE®

CONVERTING MAKESHIFT METHODS INTO ENGINEERED SOLUTIONS<sup>SM</sup>

800-321-0316 OR 760-744-6944 / FAX: 760-744-0507 / WWW.HOLDRITE.COM  
spec\_121-W\_Rev1

Product Submittal	
Job Name:	
Date:	
Part Number:	Qty:
Architect / Owner:	
Contractor:	
Notes:	