

PRODUCT SPECIFICATION DRAWING

HOLDRITE® Silencer™ Through-Stud / Suspension Clamp #261 & #262

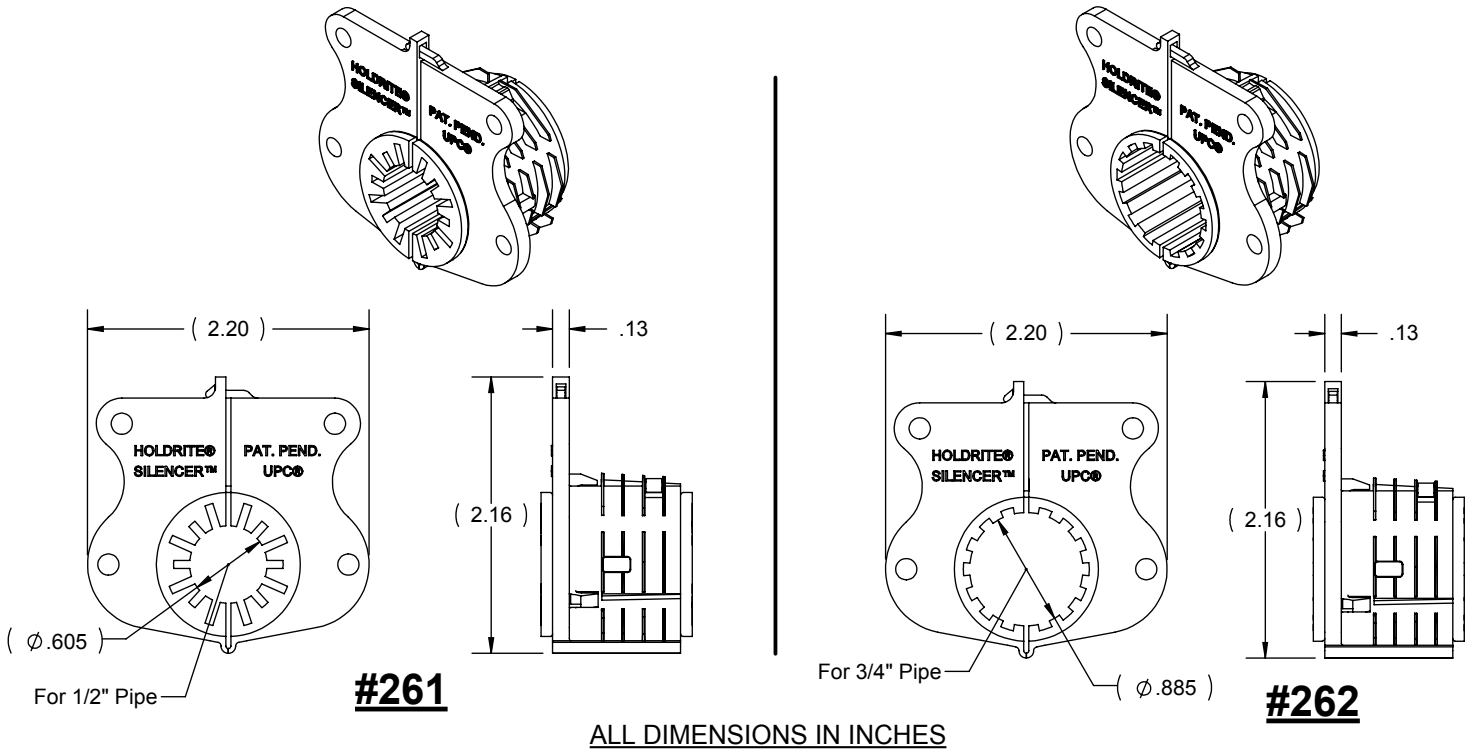

Model #'s 261 and 262 can be used as a suspension hanger, e.g., from a joist or cross-member or a HOLDRITE® Stout Bracket™, or as a through-hole isolator in wood or up to 14 gage metal framing into a 1-11/32" - 1-3/8" hole. As a through-hole isolator, they can also be used with HOLDRITE® #103, #121, and #709 series brackets. These models are used for securing and retaining tubing while providing superior acoustical isolation between the tubing and the supporting structure. Supports 1/2" and 3/4" CTS tube sizes. Supports Copper, PEX, CPVC tubing, conduit, etc. UPC listed.

Product Information:

- Material:
Shell: Polypropylene, blue, FR UL94-V2
Isolators: TPE, natural (off-white), 45 shore A
- Temperature Range: -10°F to 140°F (suspension)
-10°F to 180°F (through-stud)
- Load rating: 25 pounds in suspension mode
- UPC / IPC listed
- IAPMO listed, per standard PS42-96
- Patent Pending



THIS INFORMATION IS PROPRIETARY TO HOLDRITE AND IS SUBJECT TO CHANGE WITHOUT NOTICE. IT MAY NOT BE REPRODUCED IN PART OR WHOLE WITHOUT WRITTEN AUTHORIZATION.

HOLDRITE®

CONVERTING MAKESHIFT METHODS INTO ENGINEERED SOLUTIONS™

800-321-0316 OR 760-744-6944 / FAX: 760-744-0507 / WWW.HOLDRITE.COM
spec_261_262_RevR

Product Submittal	
Job Name:	
Date:	
Part Number:	Qty:
Architect / Owner:	
Contractor:	
Notes:	