

REMOVE OUTER SLEEVE & UNSCREW CAP.
(Fig. 1)

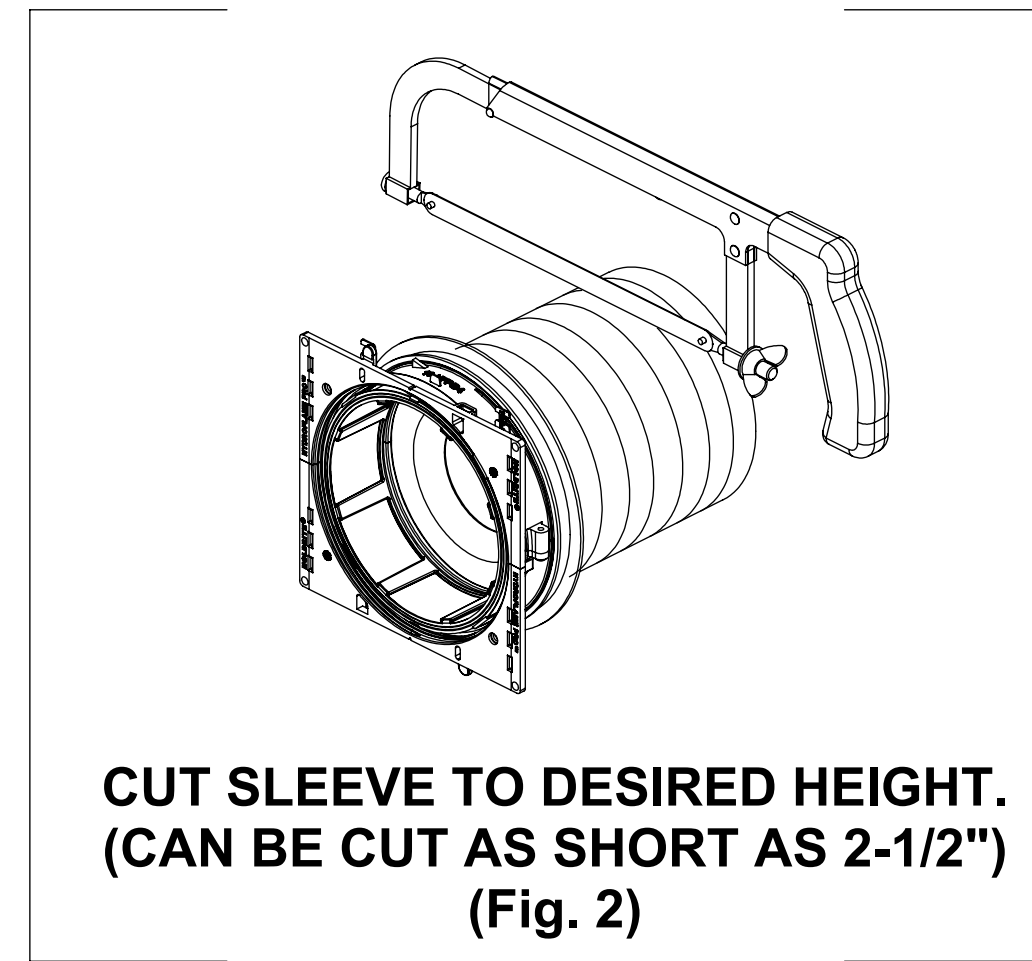

CUT SLEEVE TO DESIRED HEIGHT.
(CAN BE CUT AS SHORT AS 2-1/2")
(Fig. 2)

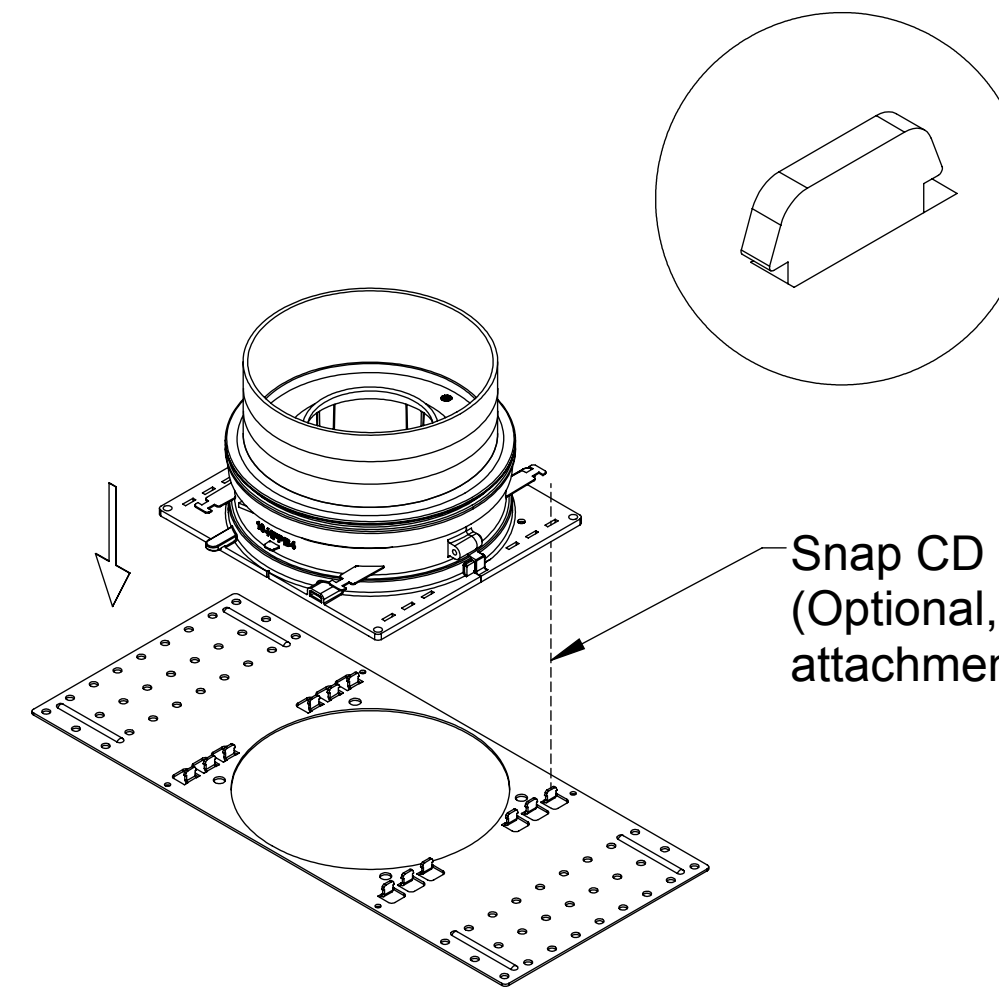

Snap CD Plate to bottom of Base, 12 places.
(Optional, #8 screws may be used to increase attachment strength)

INSTALL CD PLATE.
(Fig. 3)

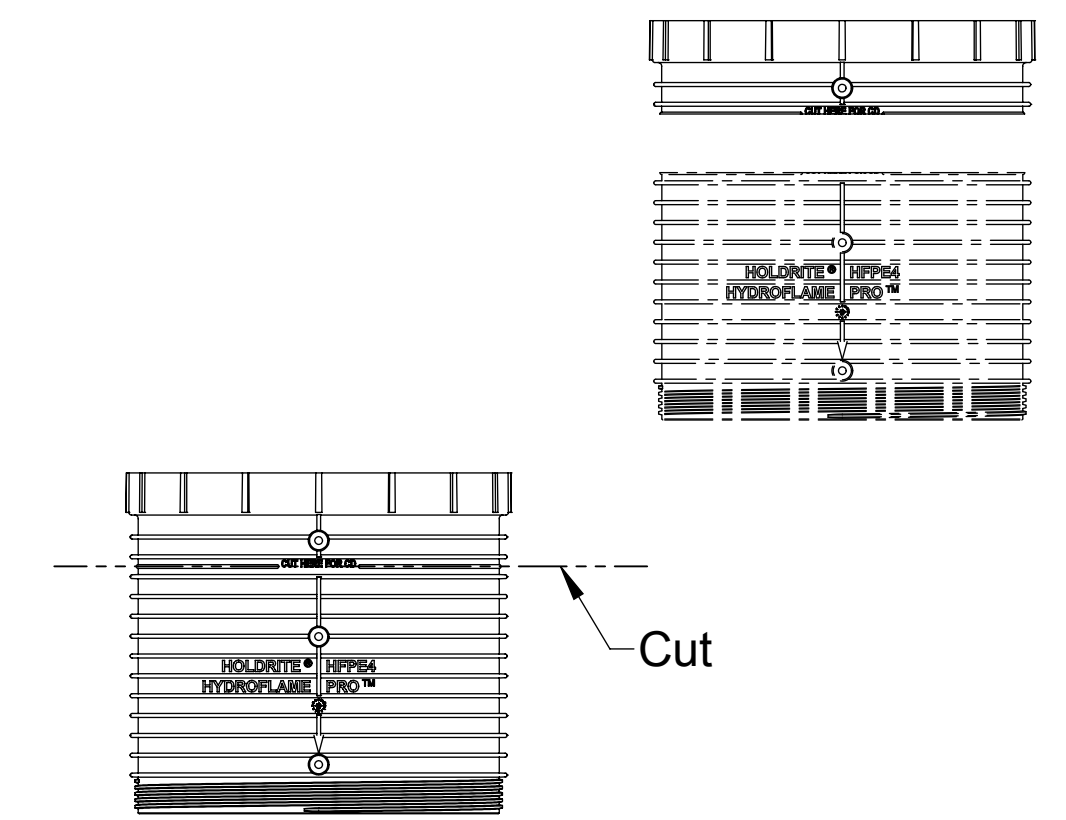

CUT OUTER SLEEVE AT MARKING THAT SAYS "CUT HERE FOR CD"
(FIG. 4)

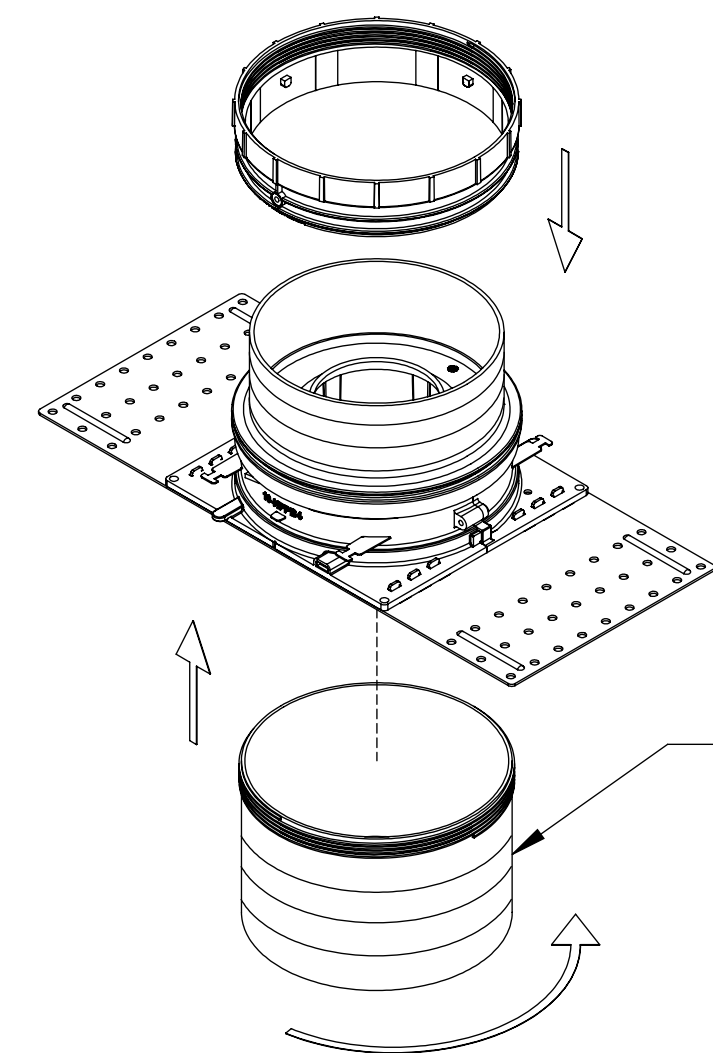

Twist Outer Sleeve, clock-wise, until tight.
(Cut short, if desired)

INSTALL INVERTED OUTER SLEEVE TO UNDER SIDE.
INSTALL MODIFIED OUTER SLEEVE TO MODIFIED INNER SLEEVE.
(Fig. 5)

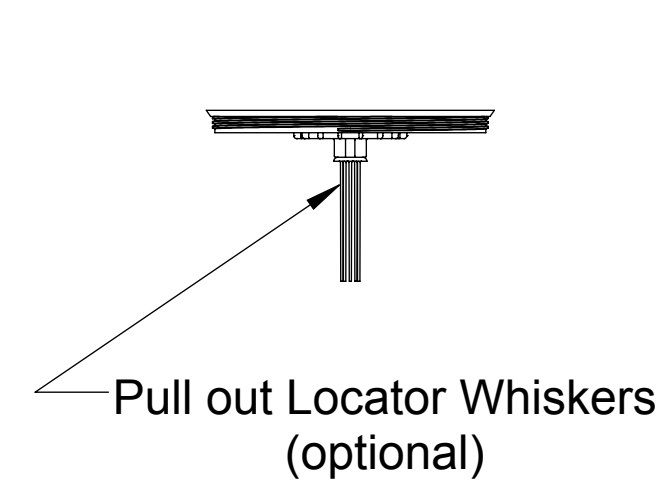

Pull out Locator Whiskers
(optional)

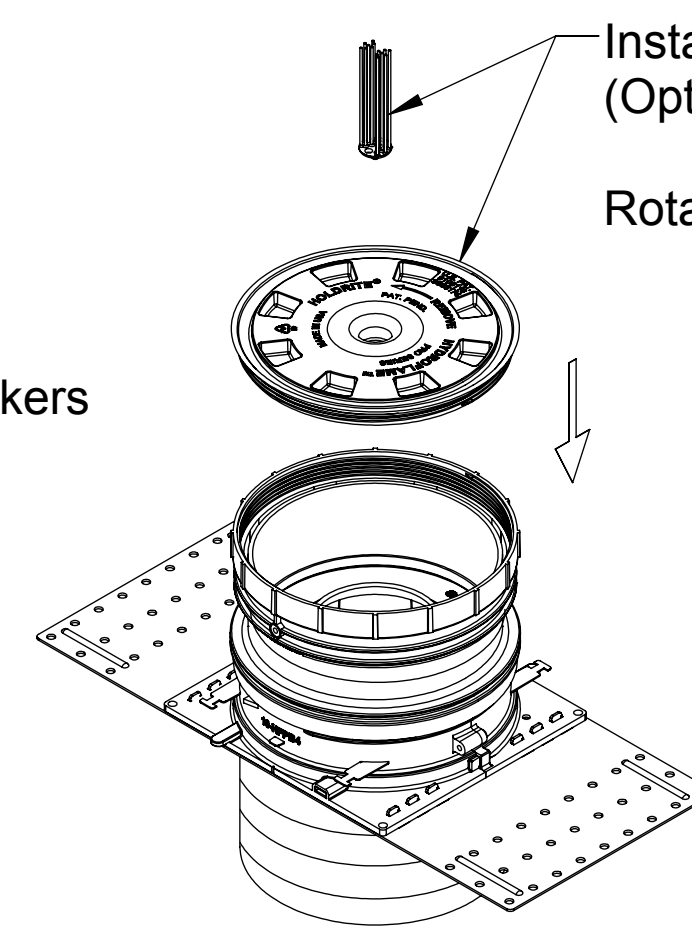

Install Locator Whiskers onto Sleeve.
(Optional, screw can be used to strenghten attachment)

Rotate Cap, clockwise, onto modified Outer Sleeve until tight.

RE-INSTALL CAP & WHISKERS.
(Fig. 6)

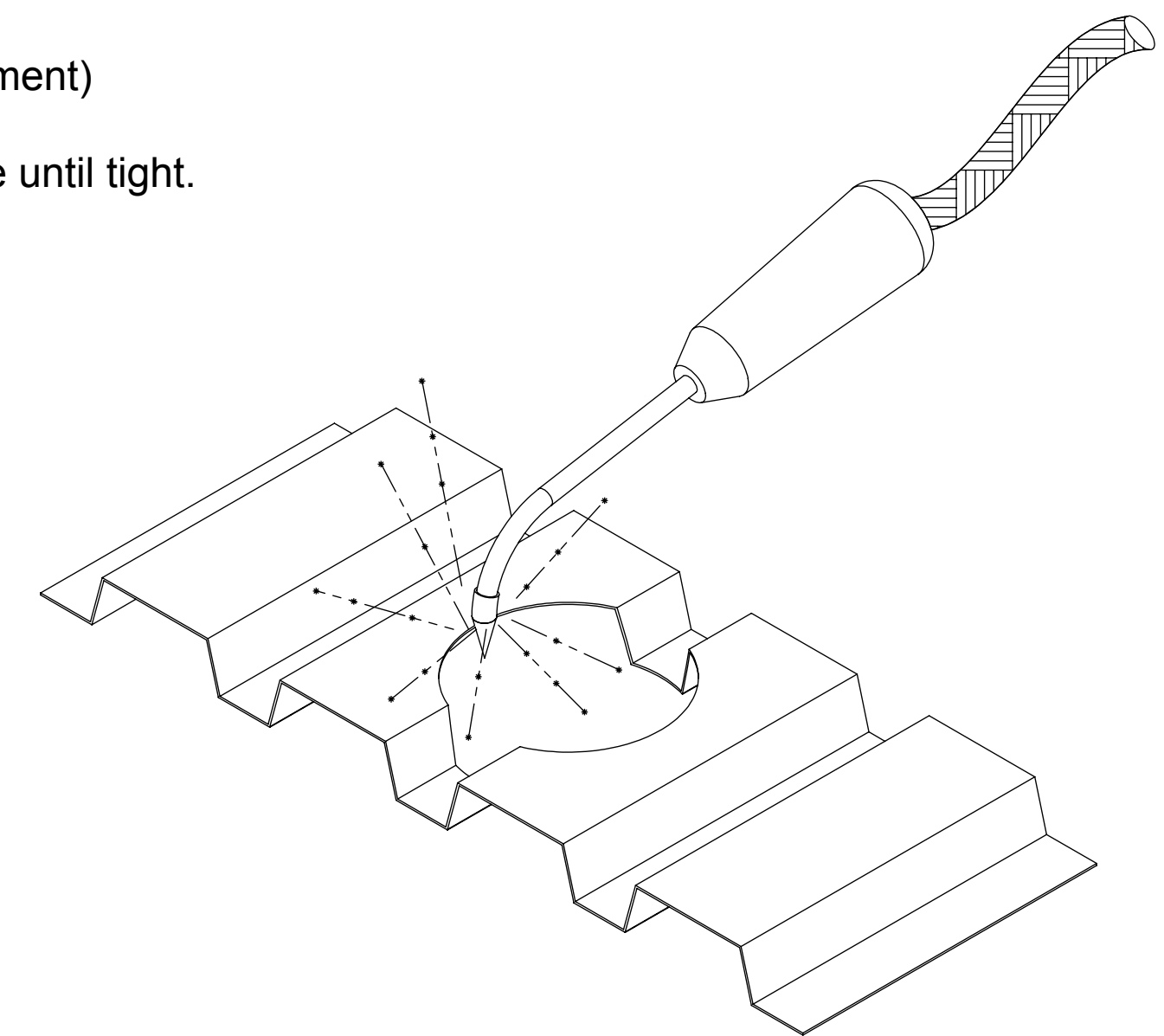

CUT HOLE IN METAL DECK.
(SEE SPEC. SHEET FOR HOLE SIZING CHART)
(Fig. 7)

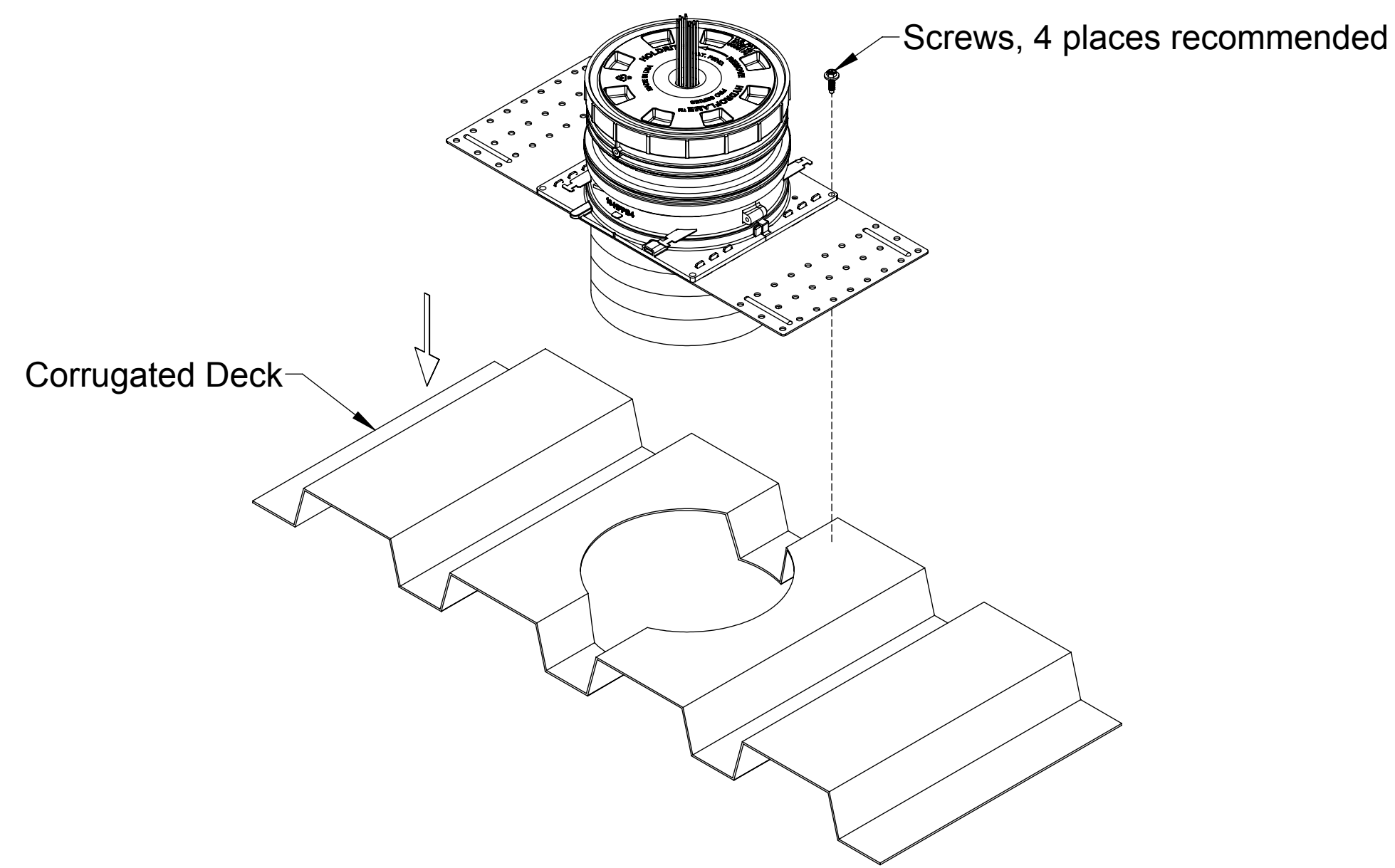

INSTALL SLEEVE ASSY INTO CORRUGATED DECK.
(Fig. 8)

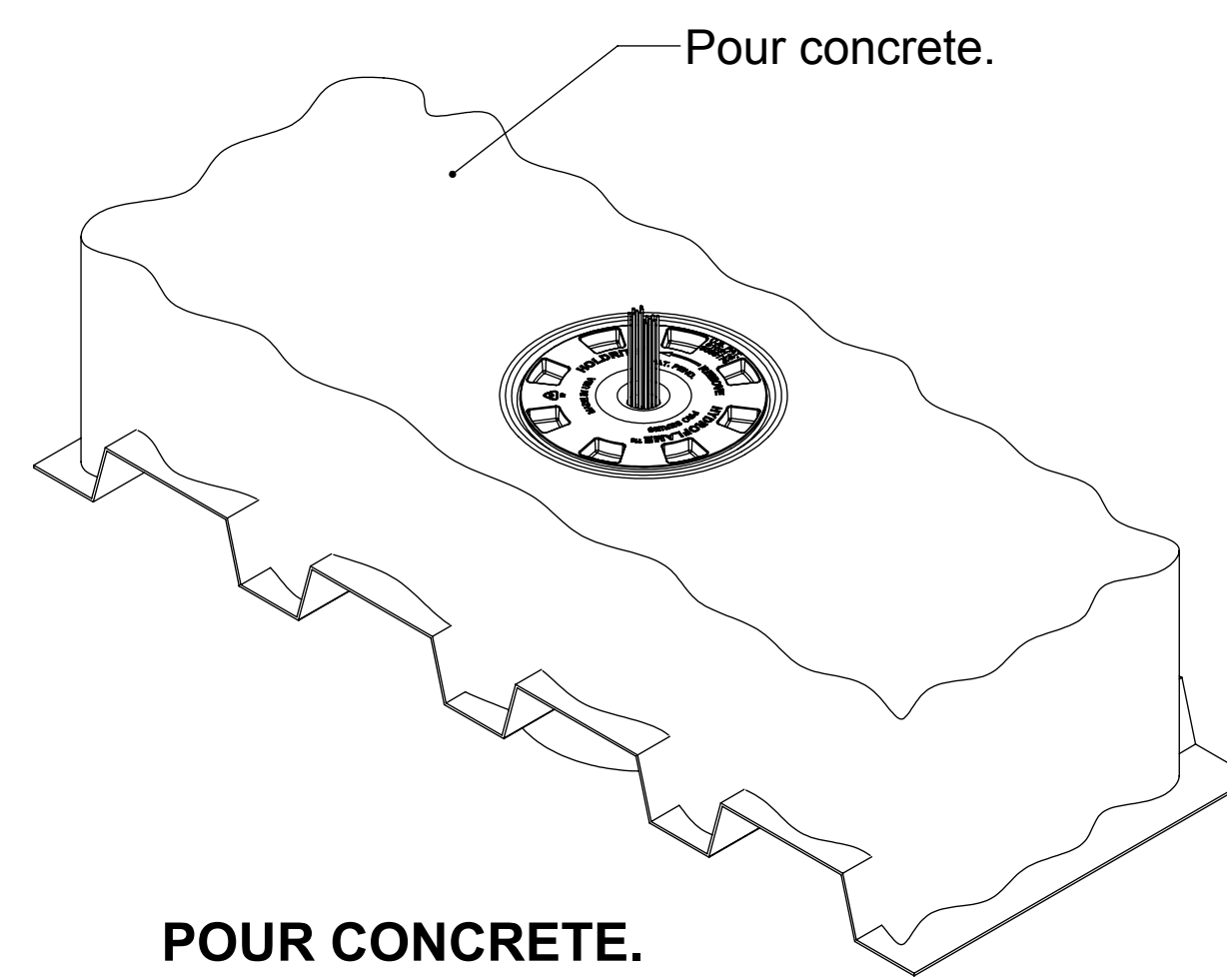

POUR CONCRETE.
(Fig. 9)

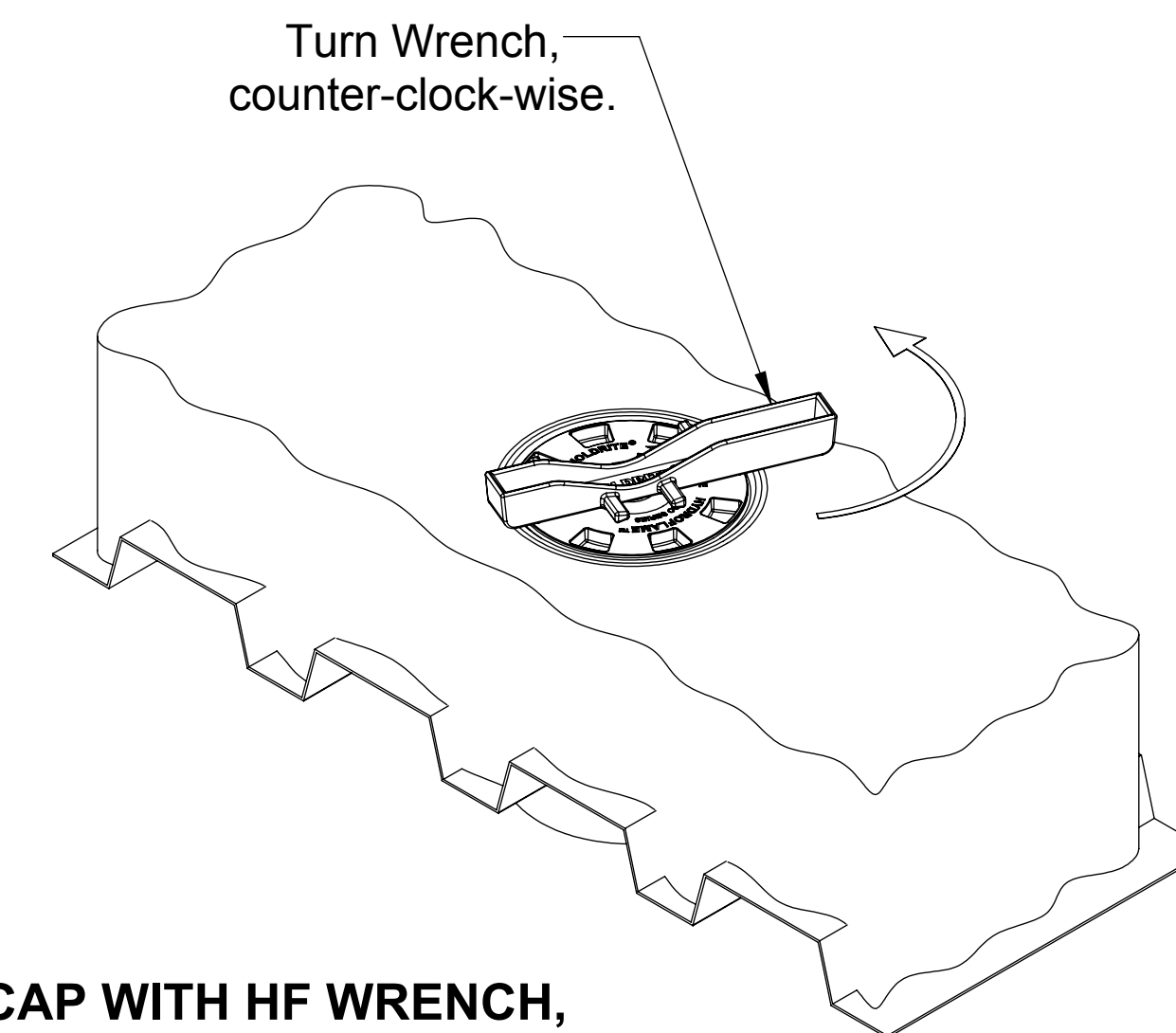

**REMOVE CAP WITH HF WRENCH,
OR BREAK-OUT WITH HAMMER.**
(Fig. 10)

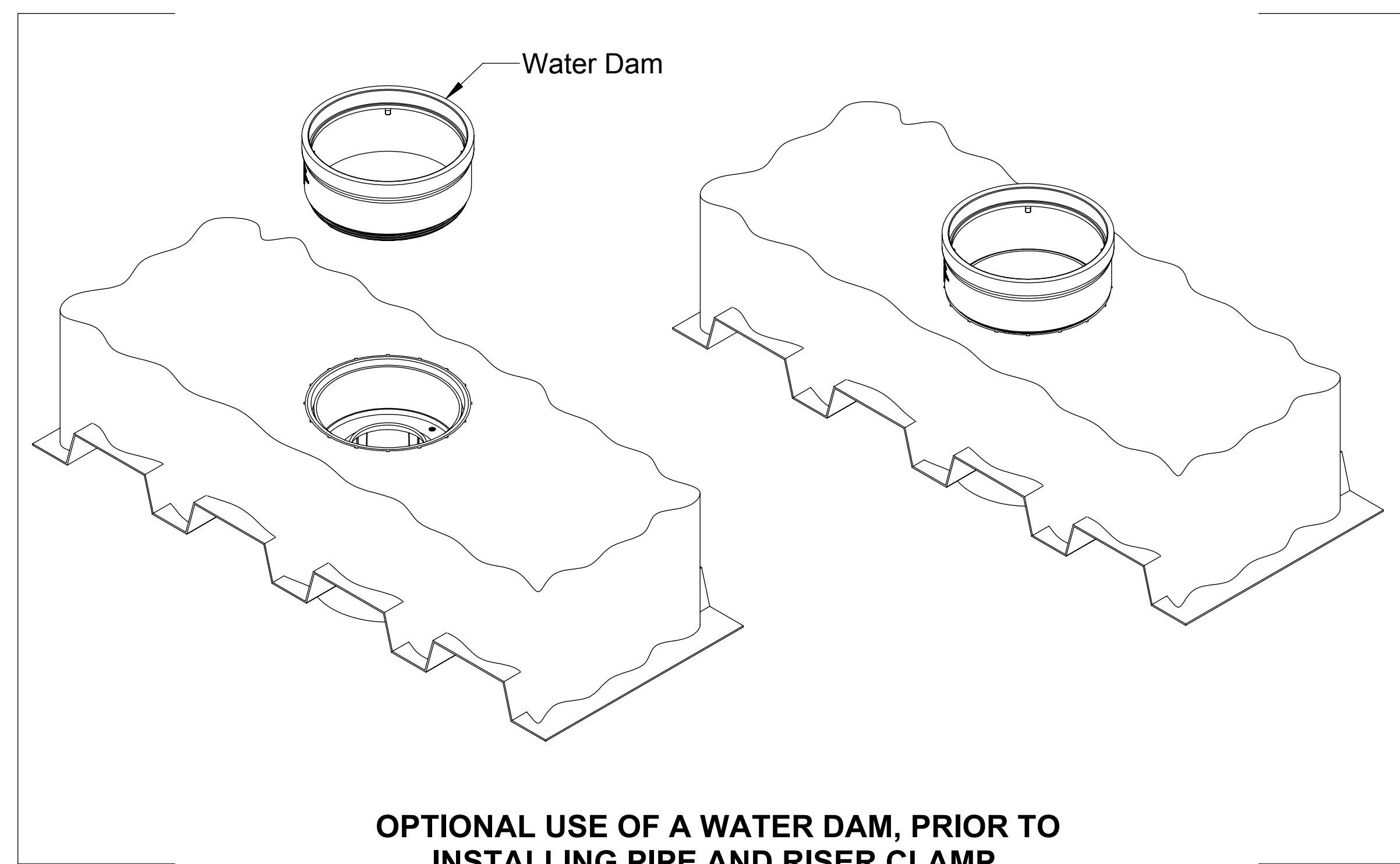

**OPTIONAL USE OF A WATER DAM, PRIOR TO
INSTALLING PIPE AND RISER CLAMP.**
(Fig. 11)

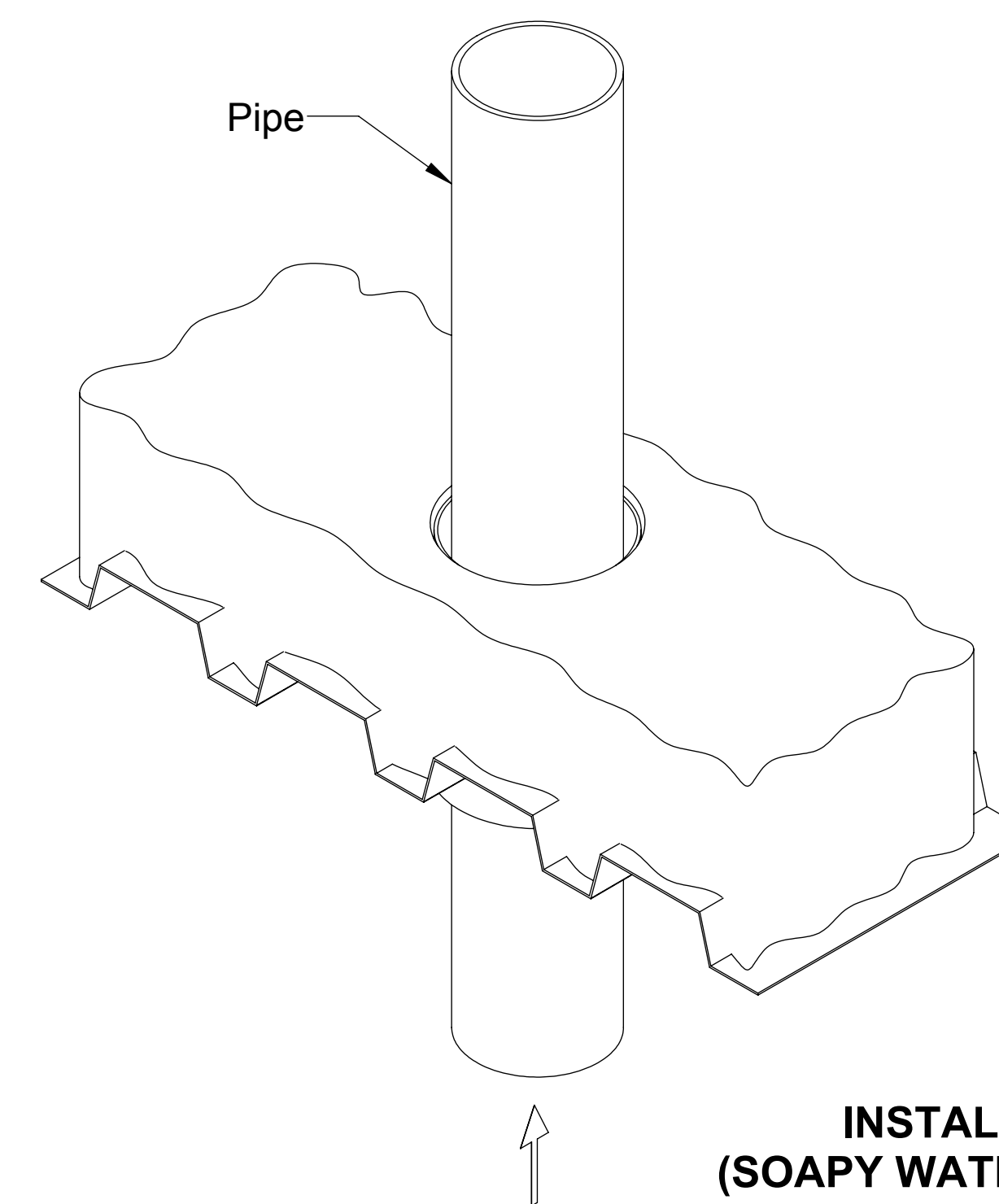

INSTALL PIPE FROM BELOW.
(SOAPY WATER EASES PIPE INSERTION)
(Fig. 12)